

MCL. CABLE LADDER THANG CÁP MCL

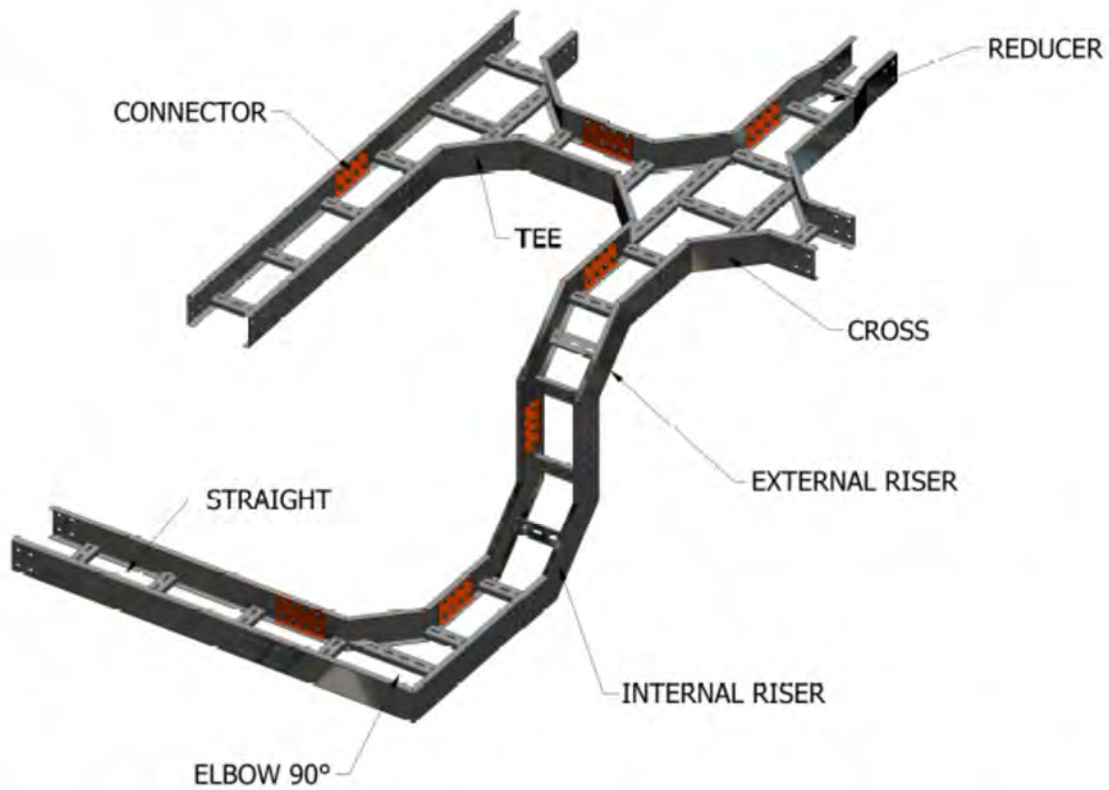

CÔNG TY CỔ PHẦN KỸ THUẬT CƠ ĐIỆN MEE
MEE MECHANICAL ELECTRICAL ENGINEERING JSC

<https://mee.com.vn>

CONTENTS – NỘI DUNG

Main characteristics - Các đặc điểm chính	3
Straight section – Thân thẳng	4
90° Flat bend – Co ngang 90°	4
Equal tee – Ngã ba bằng nhau	5
Equal cross – Ngã tư bằng nhau	5
External 90° riser - Co đứng ngoài 90°	6
Internal 90° riser - Co đứng trong 90°	6
N.1 Reducer straight - Giảm 1 cấp hai bên	7
N.1 Reducer right hand - Giảm 1 cấp bên phải	7
N.1 Reducer left hand - Giảm 1 cấp bên trái	8
Installation accessories – Phụ kiện lắp đặt	8

Thông số kỹ thuật (Technical characteristics)

Material <i>Vật liệu</i>	Mild Steel; Galvanized Steel; Stainless Steel; Aluminum <i>Thép tấm; Thép mạ kẽm; Thép không gỉ; Nhôm tấm</i>	
Finish <i>Hoàn thiện</i>	Powder coated or hot-dip galvanized after fabrication; Original finish for Stainless Steel, Galvanized Steel and Aluminum <i>Sơn tĩnh điện hoặc Nhúng kẽm nóng sau khi chế tạo cho thép tấm; Vật liệu hoàn thiện cho thép không gỉ, thép mạ kẽm và nhôm</i>	
Colour <i>Màu sắc</i>	Grey, Orange, Red, White, Ivory Beige, Green, Black, Blue and Other Colour available on request <i>Xám, cam, đỏ, trắng, trắng sữa, xanh lá cây, đen, xanh biển và màu khác có sẵn theo yêu cầu khách hàng</i>	
Dimensions <i>Kích thước</i>	Height <i>Chiều cao</i>	75mm, 100mm, 150mm, 200mm
	Width <i>Chiều rộng</i>	100mm, 150mm, 200mm, 300mm, 400mm, 500mm, 600mm, 700mm, 800mm, 1000mm, 1200mm
	Length <i>Chiều dài</i>	3000mm
Material thickness <i>Độ dày vật liệu</i>	1.2mm, 1.5mm, 2.0mm	
Covers <i>Nắp che</i>	Secured using fit Screw. Screw are included with covers as standard <i>Nắp bảo vệ sử dụng vít phù hợp. Nắp che bao gồm Vít tiêu chuẩn</i>	
Coupler Hole Diameter <i>Đường kính lỗ khớp nối</i>	M8 clearance <i>Tiêu chuẩn M8</i>	
Accessories <i>Phụ kiện</i>	Coupler, Tapping Screw, Bolt & Nut <i>Nối, ốc vít, ốc nối</i>	

MCL. CABLE LADDER – THANG CÁP MCL

STRAIGHT SECTION – THÂN THẲNG

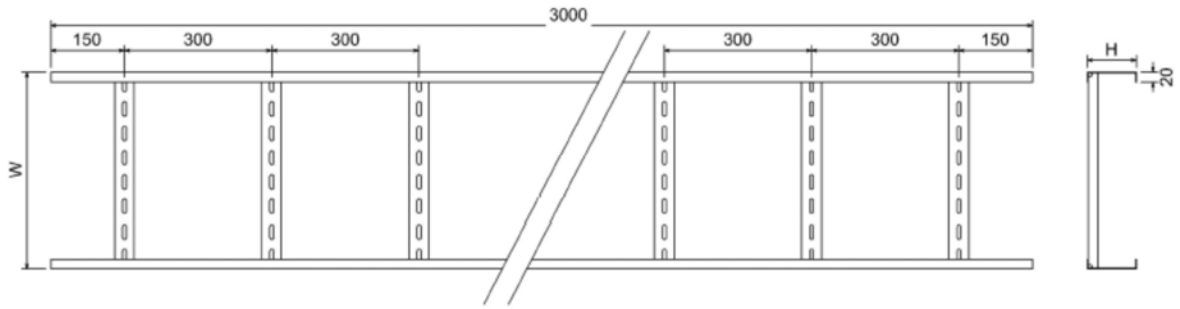

ITEM STT	ORDER CODE MÃ HÀNG	HEIGHT (H) CHIỀU CAO	WIDTH (W) CHIỀU RỘNG	MATERIAL VẬT LIỆU	THICKNESS (T) ĐỘ DÀY	LENGTH (L) CHIỀU DÀI
1	MCLB(H)01M(T)	75=75mm 10=100mm 15=150mm 20=200mm	01=100mm	M= Mild steel H=Hot dip gavanized G=Gavanized steel E=Ecogal steel Z=Zam steel S4=Stainless steel 304 S6=Stainless steel 316 A=Aluminum	12=1.2mm 15=1.5mm 20=2.0mm	3000mm
2	MCLB(H)02M(T)		02=200mm			
3	MCLB(H)03M(T)		03=300mm			
4	MCLB(H)04M(T)		04=400mm			
5	MCLB(H)05M(T)		05=500mm			
6	MCLB(H)06M(T)		06=600mm			
7	MCLB(H)07M(T)		07=700mm			
8	MCLB(H)08M(T)		08=800mm			
9	MCLB(H)09M(T)		09=900mm			
10	MCLB(H)10M(T)		10=1000mm			
11	MCLB(H)12M(T)		12=1200mm			

90° FLAT BEND - CO NGANG 90°

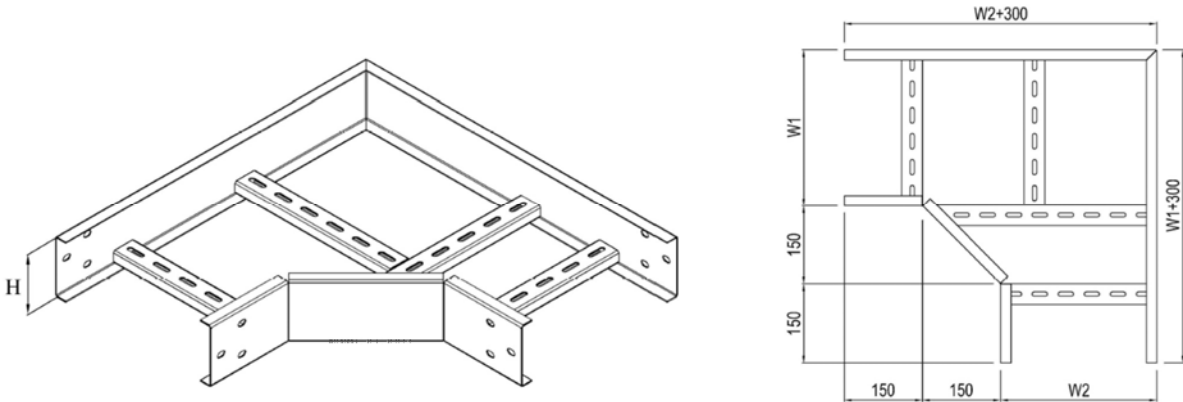

ITEM STT	ORDER CODE MÃ HÀNG	HEIGHT (H) CHIỀU CAO	WIDTH 1 (W1) CHIỀU RỘNG 1	WIDTH 2 (W2=W1) CHIỀU RỘNG 2	MATERIAL VẬT LIỆU	THICKNESS (T) ĐỘ DÀY
1	MCLE(H)01M(T)	75=75mm 10=100mm 15=150mm 20=200mm	01=100mm	01=100mm	M= Mild steel H=Hot dip gavanized G=Gavanized steel E=Ecogal steel Z=Zam steel S4=Stainless steel 304 S6=Stainless steel 316 A=Aluminum	12=1.2mm 15=1.5mm 20=2.0mm
2	MCLE(H)02M(T)		02=200mm	02=200mm		
3	MCLE(H)03M(T)		03=300mm	03=300mm		
4	MCLE(H)04M(T)		04=400mm	04=400mm		
5	MCLE(H)05M(T)		05=500mm	05=500mm		
6	MCLE(H)06M(T)		06=600mm	06=600mm		
7	MCLE(H)07M(T)		07=700mm	07=700mm		
8	MCLE(H)08M(T)		08=800mm	08=800mm		
9	MCLE(H)09M(T)		09=900mm	09=900mm		
10	MCLE(H)10M(T)		10=1000mm	10=1000mm		
11	MCLE(H)12M(T)		12=1200mm	12=1200mm		

MCL. CABLE LADDER – THANG CÁP MCL

EQUAL TEE - NGÃ BA BẰNG NHAU

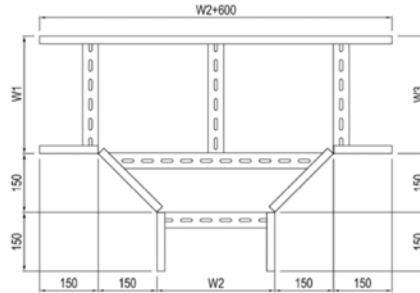
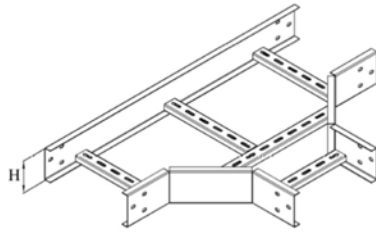

ITEM STT	ORDER CODE MÃ HÀNG	HEIGHT (H) CHIỀU CAO	WIDTH 1 (W1) CHIỀU RỘNG 1	WIDTH 2 (W2=W1) CHIỀU RỘNG 2	WIDTH 3 (W3=W1) CHIỀU RỘNG 3	MATERIAL VẬT LIỆU	THICKNESS (T) ĐỘ DÀY
1	MCLT(H)01M(T)	75=75mm 10=100mm 15=150mm 20=200mm	01=100mm	01=100mm	01=100mm	M= Mild steel H=Hot dip gavanized G=Gavanized steel E=Ecogal steel Z=Zam steel S4=Stainless steel 304 S6=Stainless steel 316 A=Aluminum	12=1.2mm 15=1.5mm 20=2.0mm
2	MCLT(H)02M(T)		02=200mm	02=200mm	02=200mm		
3	MCLT(H)03M(T)		03=300mm	03=300mm	03=300mm		
4	MCLT(H)04M(T)		04=400mm	04=400mm	04=400mm		
5	MCLT(H)05M(T)		05=500mm	05=500mm	05=500mm		
6	MCLT(H)06M(T)		06=600mm	06=600mm	06=600mm		
7	MCLT(H)07M(T)		07=700mm	07=700mm	07=700mm		
8	MCLT(H)08M(T)		08=800mm	08=800mm	08=800mm		
9	MCLT(H)09M(T)		09=900mm	09=900mm	09=900mm		
10	MCLT(H)10M(T)		10=1000mm	10=1000mm	10=1000mm		
11	MCLT(H)12M(T)		12=1200mm	12=1200mm	12=1200mm		

EQUAL CROSS - NGÃ TƯ BẰNG NHAU

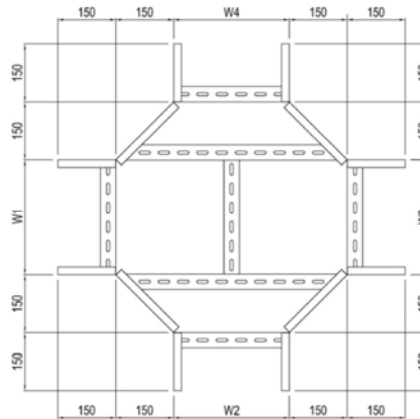
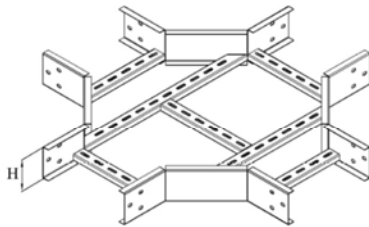

ITEM STT	ORDER CODE MÃ HÀNG	HEIGHT (H) CHIỀU CAO	WIDTH 1 (W1) CHIỀU RỘNG 1	WIDTH 2 (W2=W1) CHIỀU RỘNG 2	WIDTH 3 (W3=W1) CHIỀU RỘNG 3	WIDTH 4 (W4=W1) CHIỀU RỘNG 4	MATERIAL VẬT LIỆU	THICKNESS (T) ĐỘ DÀY
1	MCLX(H)01M(T)	75=75mm 10=100mm 15=150mm 20=200mm	01=100mm	01=100mm	01=100mm	01=100mm	M= Mild steel H=Hot dip gavanized G=Gavanized steel E=Ecogal steel Z=Zam steel S4=Stainless steel 304 S6=Stainless steel 316 A=Aluminum	12=1.2mm 15=1.5mm 20=2.0mm
2	MCLX(H)02M(T)		02=200mm	02=200mm	02=200mm	02=200mm		
3	MCLX(H)03M(T)		03=300mm	03=300mm	03=300mm	03=300mm		
4	MCLX(H)04M(T)		04=400mm	04=400mm	04=400mm	04=400mm		
5	MCLX(H)05M(T)		05=500mm	05=500mm	05=500mm	05=500mm		
6	MCLX(H)06M(T)		06=600mm	06=600mm	06=600mm	06=600mm		
7	MCLX(H)07M(T)		07=700mm	07=700mm	07=700mm	07=700mm		
8	MCLX(H)08M(T)		08=800mm	08=800mm	08=800mm	08=800mm		
9	MCLX(H)09M(T)		09=900mm	09=900mm	09=900mm	09=900mm		
10	MCLX(H)10M(T)		10=1000mm	10=1000mm	10=1000mm	10=1000mm		
11	MCLX(H)12M(T)		12=1200mm	12=1200mm	12=1200mm	12=1200mm		

MCL. CABLE LADDER – THANG CÁP MCL

EXTERNAL 90° RISER - CO ĐỨNG NGOÀI 90°

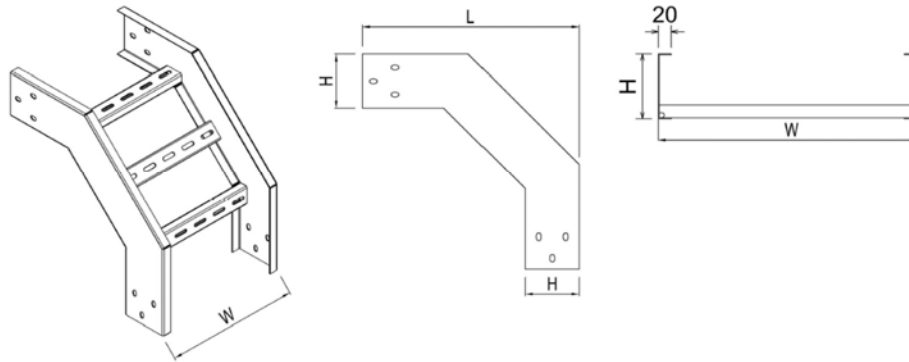

ITEM STT	ORDER CODE MÃ HÀNG	HEIGHT (H) CHIỀU CAO	WIDTH (W) CHIỀU RỘNG	MATERIAL VẬT LIỆU	THICKNESS (T) ĐỘ DÀY
1	MCLO(H)01M(T)	75=75mm 10=100mm 15=150mm 20=200mm	01=100mm	M= Mild steel H=Hot dip gavanized G=Gavanized steel E=Ecogal steel Z=Zam steel S4=Stainless steel 304 S6=Stainless steel 316 A=Aluminum	12=1.2mm 15=1.5mm 20=2.0mm
2	MCLO(H)02M(T)		02=200mm		
3	MCLO(H)03M(T)		03=300mm		
4	MCLO(H)04M(T)		04=400mm		
5	MCLO(H)05M(T)		05=500mm		
6	MCLO(H)06M(T)		06=600mm		
7	MCLO(H)07M(T)		07=700mm		
8	MCLO(H)08M(T)		08=800mm		
9	MCLO(H)09M(T)		09=900mm		
10	MCLO(H)10M(T)		10=1000mm		
11	MCLO(H)12M(T)		12=1200mm		

INTERNAL 90° RISER - CO ĐỨNG TRONG 90°

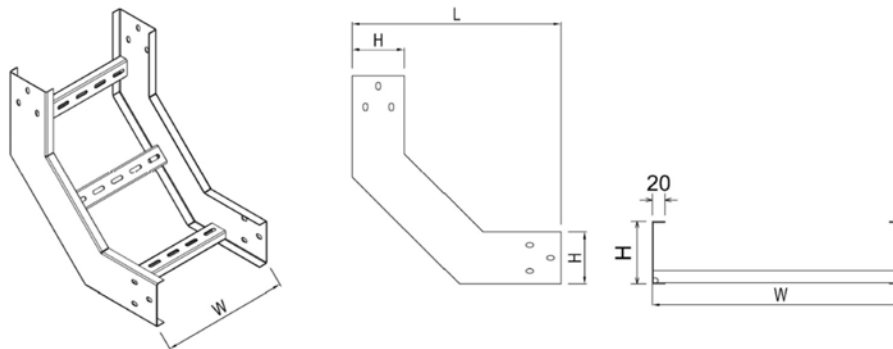

ITEM STT	ORDER CODE MÃ HÀNG	HEIGHT (H) CHIỀU CAO	WIDTH (W) CHIỀU RỘNG	MATERIAL VẬT LIỆU	THICKNESS (T) ĐỘ DÀY
1	MCLI(H)01M(T)	75=75mm 10=100mm 15=150mm 20=200mm	01=100mm	M= Mild steel H=Hot dip gavanized G=Gavanized steel E=Ecogal steel Z=Zam steel S4=Stainless steel 304 S6=Stainless steel 316 A=Aluminum	12=1.2mm 15=1.5mm 20=2.0mm
2	MCLI(H)02M(T)		02=200mm		
3	MCLI(H)03M(T)		03=300mm		
4	MCLI(H)04M(T)		04=400mm		
5	MCLI(H)05M(T)		05=500mm		
6	MCLI(H)06M(T)		06=600mm		
7	MCLI(H)07M(T)		07=700mm		
8	MCLI(H)08M(T)		08=800mm		
9	MCLI(H)09M(T)		09=900mm		
10	MCLI(H)10M(T)		10=1000mm		
11	MCLI(H)12M(T)		12=1200mm		

MCL. CABLE LADDER – THANG CÁP MCL

N.1 REDUCER STRAIGHT - GIẢM 1 CẤP HAI BÊN

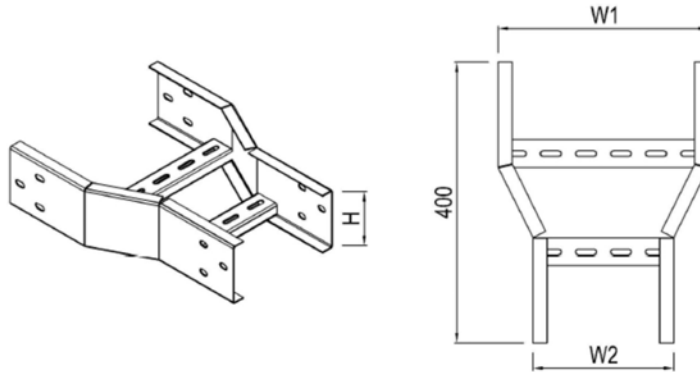

ITEM STT	ORDER CODE MÃ HÀNG	HEIGHT (H) CHIỀU CAO	WIDTH 1 (W1) CHIỀU RỘNG 1	WIDTH 2 (W2) CHIỀU RỘNG 2	MATERIAL VẬT LIỆU	THICKNESS (T) ĐỘ DÀY
1	MCL1S(H)0201M(T)	75=75mm 10=100mm 15=150mm 20=200mm	02=200mm	01=100mm	M= Mild steel H=Hot dip gavanized G=Gavanized steel E=Ecogal steel Z=Zam steel S4=Stainless steel 304 S6=Stainless steel 316 A=Aluminum	12=1.2mm 15=1.5mm 20=2.0mm
2	MCL1S(H)0302M(T)		03=300mm	02=200mm		
3	MCL1S(H)0403M(T)		04=400mm	03=300mm		
4	MCL1S(H)0504M(T)		05=500mm	04=400mm		
5	MCL1S(H)0605M(T)		06=600mm	05=500mm		
6	MCL1S(H)0706M(T)		07=700mm	06=600mm		
7	MCL1S(H)0807M(T)		08=800mm	07=700mm		
8	MCL1S(H)0908M(T)		09=900mm	08=800mm		
9	MCL1S(H)1009M(T)		10=1000mm	09=900mm		
10	MCL1S(H)1210M(T)		12=1200mm	10=1000mm		

N.1 REDUCER RIGHT HAND - GIẢM 1 CẤP BÊN PHẢI

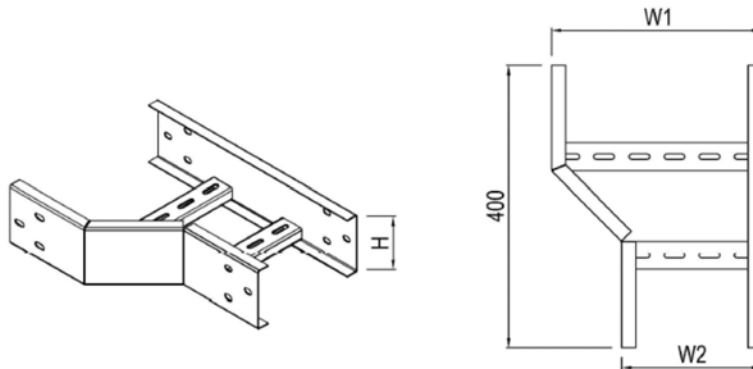

ITEM STT	ORDER CODE MÃ HÀNG	HEIGHT (H) CHIỀU CAO	WIDTH 1 (W1) CHIỀU RỘNG 1	WIDTH 2 (W2) CHIỀU RỘNG 2	MATERIAL VẬT LIỆU	THICKNESS (T) ĐỘ DÀY
1	MCL1R(H)0201M(T)	75=75mm 10=100mm 15=150mm 20=200mm	02=200mm	01=100mm	M= Mild steel H=Hot dip gavanized G=Gavanized steel E=Ecogal steel Z=Zam steel S4=Stainless steel 304 S6=Stainless steel 316 A=Aluminum	12=1.2mm 15=1.5mm 20=2.0mm
2	MCL1R(H)0302M(T)		03=300mm	02=200mm		
3	MCL1R(H)0403M(T)		04=400mm	03=300mm		
4	MCL1R(H)0504M(T)		05=500mm	04=400mm		
5	MCL1R(H)0605M(T)		06=600mm	05=500mm		
6	MCL1R(H)0706M(T)		07=700mm	06=600mm		
7	MCL1R(H)0807M(T)		08=800mm	07=700mm		
8	MCL1R(H)0908M(T)		09=900mm	08=800mm		
9	MCL1R(H)1009M(T)		10=1000mm	09=900mm		
10	MCL1R(H)1210M(T)		12=1200mm	10=1000mm		

MCL. CABLE LADDER – THANG CẤP MCL

N.1 REDUCER LEFT HAND - GIẢM 1 CẤP BÊN TRÁI

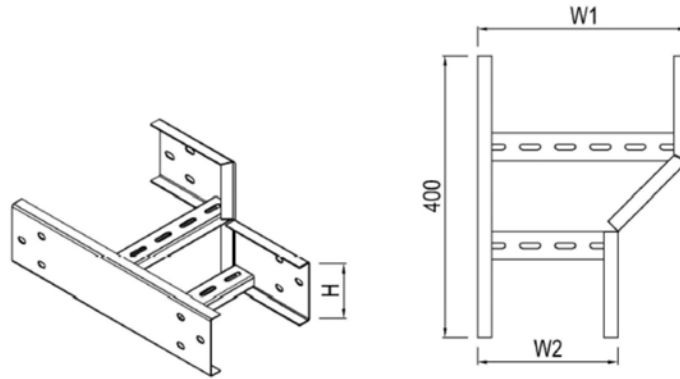

ITEM STT	ORDER CODE MÃ HÀNG	HEIGHT (H) CHIỀU CAO	WIDTH 1 (W1) CHIỀU RỘNG 1	WIDTH 2 (W2) CHIỀU RỘNG 2	MATERIAL VẬT LIỆU	THICKNESS (T) ĐỘ DÀY
1	MCL1L(H)0201M(T)	75=75mm 10=100mm 15=150mm 20=200mm	02=200mm	01=100mm	M= Mild steel H=Hot dip gavanized G=Gavanized steel E=Ecogal steel Z=Zam steel S4=Stainless steel 304 S6=Stainless steel 316 A=Aluminum	12=1.2mm 15=1.5mm 20=2.0mm
2	MCL1L(H)0302M(T)		03=300mm	02=200mm		
3	MCL1L(H)0403M(T)		04=400mm	03=300mm		
4	MCL1L(H)0504M(T)		05=500mm	04=400mm		
5	MCL1L(H)0605M(T)		06=600mm	05=500mm		
6	MCL1L(H)0706M(T)		07=700mm	06=600mm		
7	MCL1L(H)0807M(T)		08=800mm	07=700mm		
8	MCL1L(H)0908M(T)		09=900mm	08=800mm		
9	MCL1L(H)1009M(T)		10=1000mm	09=900mm		
10	MCL1L(H)1210M(T)		12=1200mm	10=1000mm		

INSTALLATION ACCESSORIES – PHỤ KIỆN LẮP ĐẶT

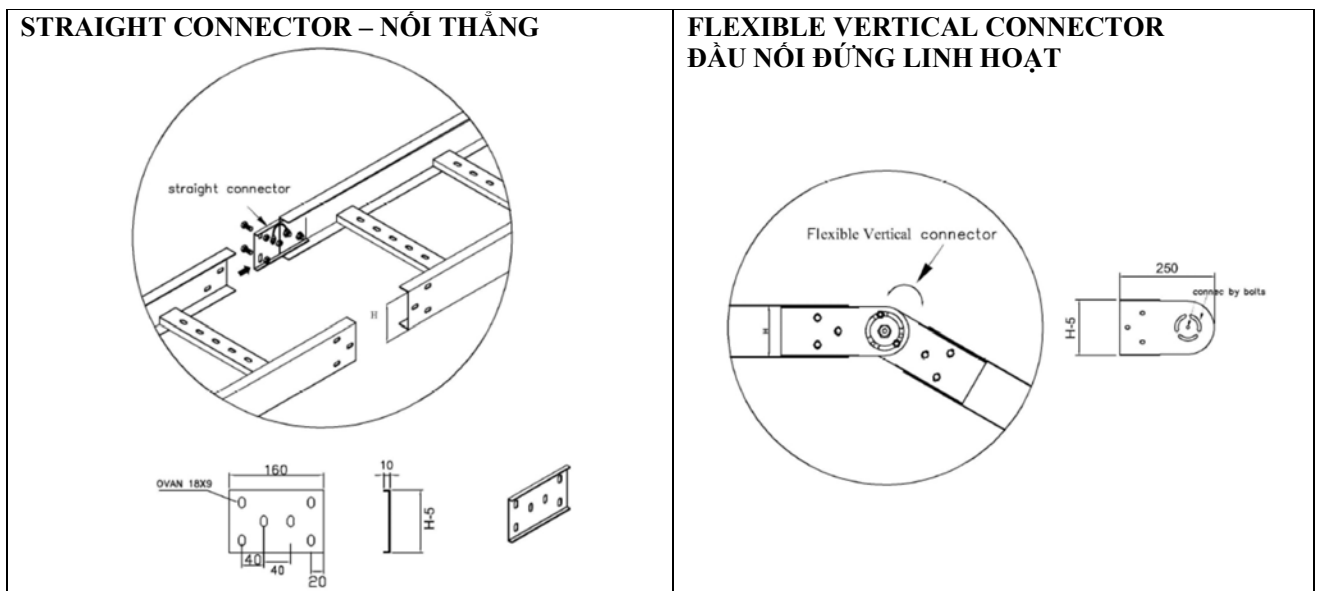

MCL. CABLE LADDER – THANG CÁP MCL

FLEXIBLE HORIZONTAL CONNECTOR ĐẦU NỐI NGANG LINH HOẠT

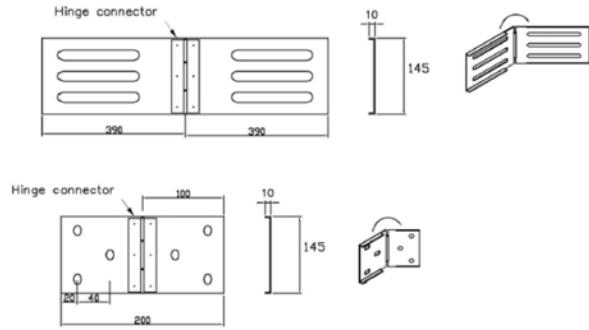

Z CLAMP FOR LADDER KẸP Z CHO THANG CÁP

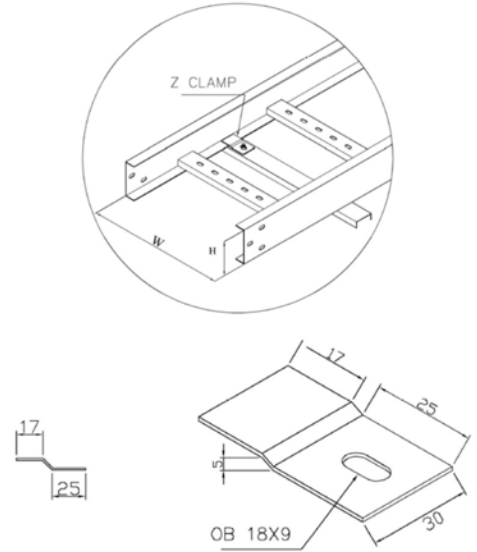

COVER CLAMP KẸP NẮP

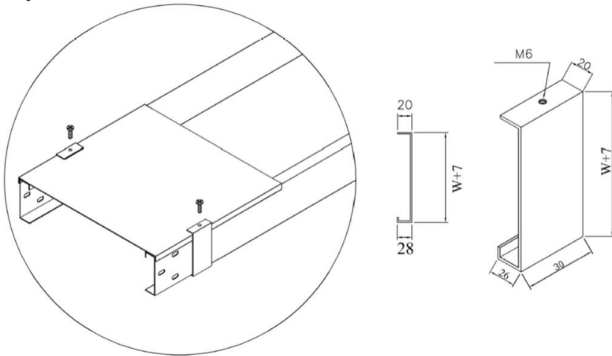

STOP END CHẶN CUỐI

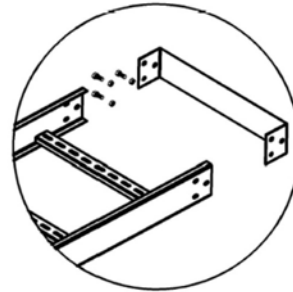

WALL BRACKET GIÁ ĐỠ TREO TƯỜNG

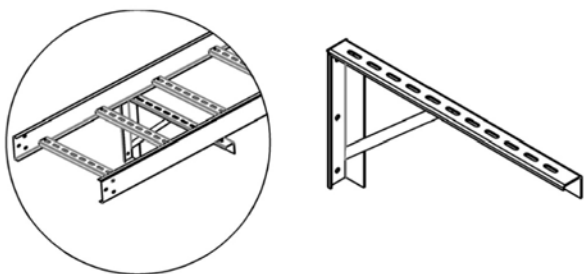

QUALITY
EFFICIENCY
PROFESSIONAL



CÔNG TY CỔ PHẦN KỸ THUẬT CƠ ĐIỆN MEE
MEE MECHANICAL ELECTRICAL ENGINEERING JSC

Lô HT-E10-6-9, Đường số 19, Khu công nghiệp
Hiệp Phước, Xã Hiệp Phước, Huyện Nhà Bè, TP.
Hồ Chí Minh, Việt Nam Mã số thuế:
0310439936

Lot HT-E10-6-9, Road 19, Hiep Phuoc
Industrial Park, Hiep Phuoc Commune, Nha
Be Dist., Ho Chi Minh City, Vietnam
Tax code: 0310439936

www.mee.com.vn

+84 938 848 788

info@mee.com.vn